

# HYDRATION STATIONS & DRINKING FOUNTAINS

## GENERAL NOTES

- P** Proposed locations, QTY = 5
- HD** Hydration Station & ADA Drinking Fountain, QTY = 3
- H** Hydration Station, QTY = 1
- D** ADA Drinking Fountain, QTY = 11
- BD** ADA Drinking Fountain & Bottle Filler, QTY = 12
- ND** Non-ADA Drinking Fountain, QTY = 5

## LEGEND

- AREA OF WORK: OUTER CAMPUS SITE IMPROVEMENTS
- - - ALTERNATE BID ITEM. SEE NOTE FOR BID NUMBER.
- ▲ VEHICULAR SIGN SYMBOL; TRIANGLE INDICATES FRONT SIDE OF SIGN W/TEXT. SEE SHEETS A-120 AND 1-121 FOR SCHEDULE, PLANS AND CORRELATIVE DETAILS. VEHICULAR SIGN SYMBOL; TRIANGLE INDICATES FRONT SIDE OF SIGN. NIC SIGNS ARE NOT A PART OF THIS PROJECT SCOPE.



NO.	ISSUES/REVISIONS	DATE
	DSA SUBMITTAL	10/04/11
	DSA INCREMENT 1 BACKCHECK	3/29/12
	BID SET	3/6/13

DIVISION OF THE STATE ARCHITECT	
APPL #01-112282	
FILE # 43-C2	
AC _____	FLS _____
SSS _____	DATE _____
IDENTIFICATION STAMP	

KEY PLAN

PROJECT #162 PARKING AND CIRCULATION PHASE 2  
BID DOCUMENT #1640-162  
WRNS #07017.02

DATE: 2/15/13 DRAWN BY:  
SCALE: 1"=100'-0" CHECKED BY:

SHEET TITLE:

**OUTER CAMPUS  
SITE PLAN**

SHEET NO:

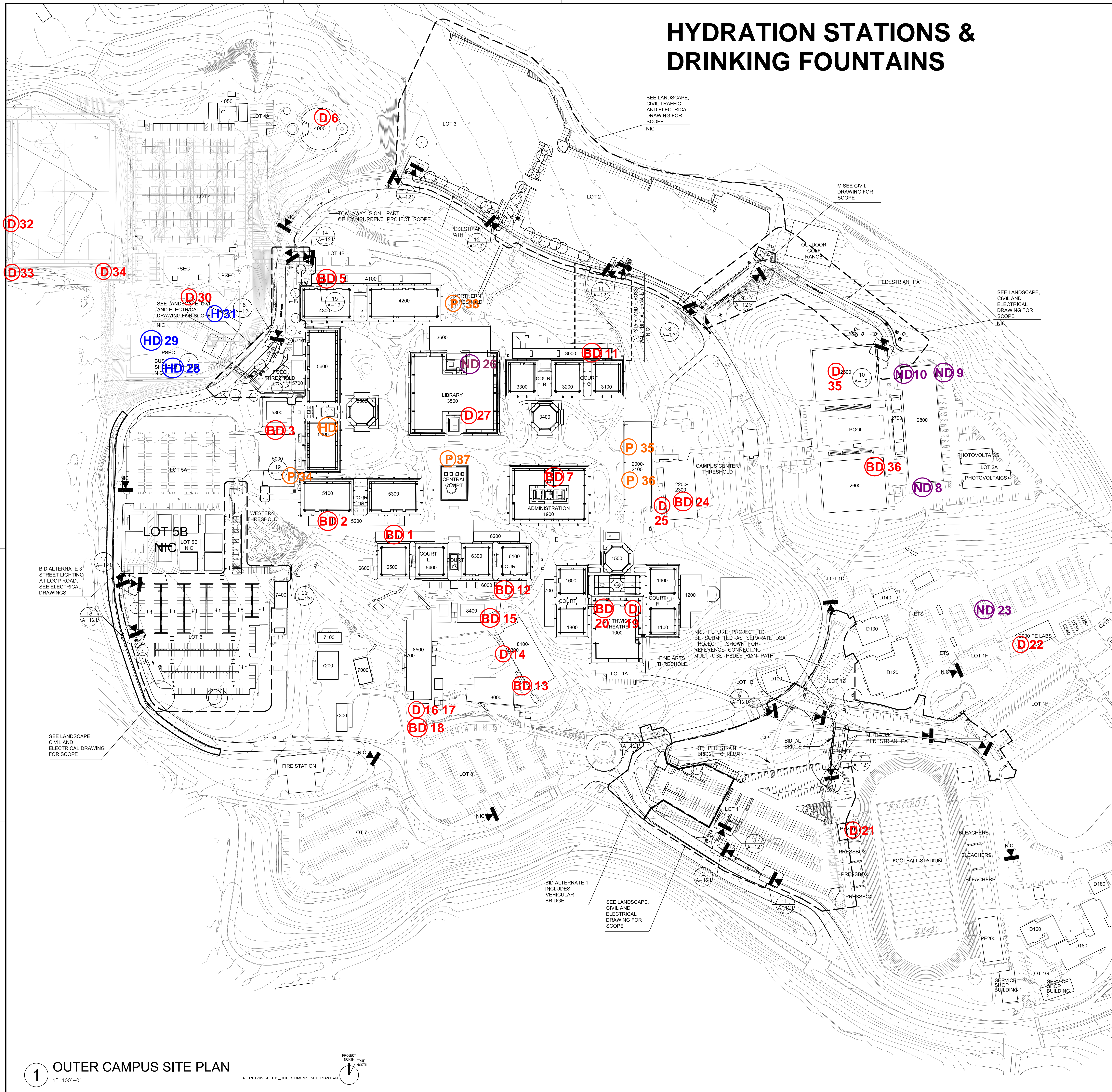

**1** OUTER CAMPUS SITE PLAN  
1"=100'-0"

All drawings and written material appearing herein constitute original and unpublished work of the Architect/Engineer and may not be duplicated, used or disclosed without consent of Architect/Engineer.

If this drawing is not 30"x42", then the drawing has been revised from its original size. Notes scales must be adjusted. This line should be equal to one inch.